

# 5-Ply Particleboard Core Door

NON-RATED,  
FIRE RATED 20 MINUTE\*

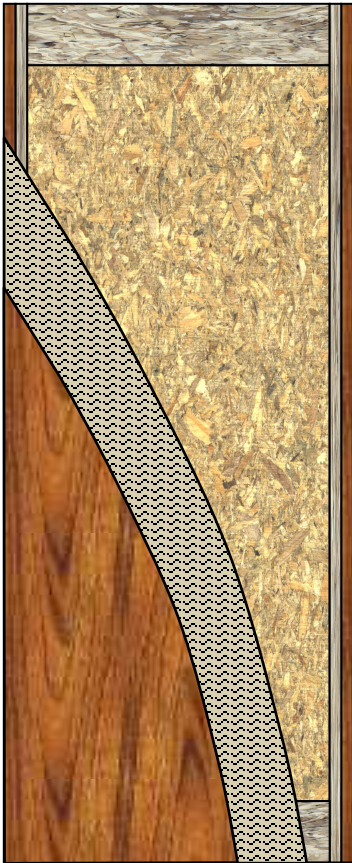

## THICKNESS

Non-rated 1 3/4" , 1 3/8" , 2 1/4"  
20 Minute\* 1 3/4"

## MAXIMUM SIZE

Single (No Label) 4/0 x 10/0  
Pairs (No Label) 8/0 x 10/0  
Single (20 Minute\*) 3/0 x 9/0 or 4/0 x 8/0  
Pair (20 Minute\*) 8/0 x 8/0 (4/0 each leaf)  
Double Egress Pair (20 Minute\*) 8/0 x 8/0 (4/0 each leaf)  
Door & Transom (20 Minute\*) 3/0 x 10/0 overall

## METHOD OF CONSTRUCTION

5 Ply, Hot Pressed, Bonded Core, Calibrated Thickness.

## CORE

ANSI/A 208.1, Grade 1-LD-2, Density 33 lbs./cu. ft.. Stiles and rails bonded to core and calibrate sanded prior to press.

## CROSSBANDS

1/16" or 1/11" Engineered Fiber

## FACE

Wood Veneers, Medium Density Overlays (MDO), Decorative High Pressure Laminate.

## STILES

1 5/8" two ply – Outer 1/2" matches face veneer – Inner ply is Laminated Strand Lumber (LSL) or mill option. Bonded to Core.

## TOP & BOTTOM RAILS

Standard 1 1/2" " Laminated Strand Lumber (LSL) or mill option. Bonded to Core. Additional blocking available as requested.

## FACE ASSEMBLY ADHESIVE

Type 1, Waterproof glue

## MAX. LITE OPENINGS

**Non-rated** – Total area of openings not to exceed 1296 sq. in. of visible glass or one continuous dimension of 54" in height or one continuous dimension of 38" in width

**20 Minute\*** - Total area of openings not to exceed 1296 sq. in. of visible glass or one continuous dimension of 54" in height or one continuous dimension of 30" in width

## FINISH

Clear, Custom Stain, Prime, Seal or opaque.

## DETAIL

Factory fitting and complete factory machining including lights, louvers and applied moldings

## WARRANTY

Full; Life of original installation

**Exterior door applications is not recommended or warranted**

\* Neutral pressure tested



# 5-Ply Structural Composite Lumber Core Door

NON-RATED,  
FIRE RATED 20 MINUTE\*



## THICKNESS

Non-rated 1 3/4"  
20 Minute\* 1 3/4"

## MAXIMUM SIZE

Single (No Label) 4/0 x 10/0  
Pairs (No Label) 8/0 x 10/0  
Single (20 Minute\*) 3/0 x 9/0 or 4/0 x 8/0  
Pair (20 Minute\*) 8/0 x 8/0 (4/0 each leaf)  
Double Egress Pair (20 Minute\*) 8/0 x 8/0 (4/0 each leaf)  
Door & Transom (20 Minute\*) 3/0 x 10/0 overall

## METHOD OF CONSTRUCTION

5 Ply, Hot Pressed, Bonded Core, Calibrated Thickness.

## CORE

Laminated Strand Lumber

## CROSSBANDS

1/16" or 1/11" Engineered Fiber

## FACE

Wood Veneers, Medium Density Overlays (MDO),  
Decorative High Pressure Laminate.

## STILES

1 5/8" two ply – Outer 1/2" matches face veneer – Inner ply is  
Laminated Strand Lumber (LSL) or mill option. Bonded to  
Core.

## TOP & BOTTOM RAILS

1 1/2" Laminated Strand Lumber (LSL) or mill option.  
Bonded to Core. Additional blocking available upon request.

## FACE ASSEMBLY ADHESIVE

Type 1, Waterproof glue

## MAX. LITE OPENINGS

**Non-rated** – Total area of openings not to exceed 2835 sq.  
in. of visible glass or one continuous dimension of 81" in  
height or one continuous dimension of 38" in width  
**20 Minute\*** - Total area of openings not to exceed 1296 sq.  
in. of visible glass or one continuous dimension of 54" in  
height or one continuous dimension of 30" in width

## FINISH

Clear, Custom Stain, Prime, Seal or opaque.

## DETAIL

Factory fitting and complete factory machining including  
lights, louvers and applied moldings

## WARRANTY

Full; Life of original installation  
**Exterior door applications is not recommended or  
warranted**

\* Negative pressure tested



# 5-Ply Holid<sup>®</sup> Core Door

NON-RATED

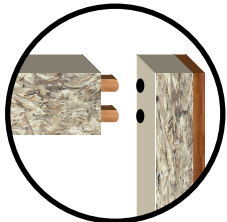
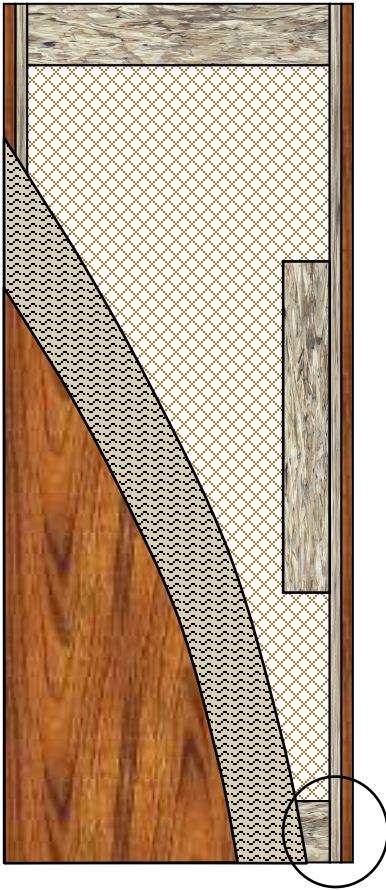

2 Each 1-1/2" x 1/4"  
Dowel Pins

®Patented by Ohio Valley Door Corporation in 1976. This unique product combines the strength of solid core with the lightweight of hollow core to provide a strong yet versatile architectural door.

## THICKNESS

Non-rated 1 3/4" , 1 3/8"

## MAXIMUM SIZE

Single (No Label) 4/0 x 10/0  
Pairs (No Label) 8/0 x 10/0 (4/0 each)

## METHOD OF CONSTRUCTION

5 Ply, Hot Pressed

## CORE

3/8" Cell size, 42 lb. Paper, crushing strength 93.8 lb./inch

## CROSSBANDS

1/11" Engineered Fiber

## FACE:

Wood Veneers, Medium Density Overlays (MDO),  
Decorative High Pressure Laminate.

## STILES

1-5/8" two ply – Outer 1/2" matches face veneer – Inner ply is  
Laminated Strand Lumber (LSL)

## TOP & BOTTOM RAILS

3 1/2" , mill option (Dowel pin joinery – see detail at left)

## INNER BLOCKING

Standard – 3 3/8" x 36"

## FACE ASSEMBLY ADHESIVE

Type 1, Waterproof glue

## MAX. LITE OPENINGS

To satisfy warranty requirements, must not exceed 40% of  
door area or 1/2 door height

## FINISH

Clear, Custom Stain, Prime, Seal or opaque.

## DETAIL

Factory fitting and complete factory machining including  
lights, louvers and applied moldings

## WARRANTY

2 Years - Interior

**Exterior door applications is not recommended or  
warranted**



# 5-Ply Stave Lumber Core Door

NON-RATED,  
FIRE RATED 20 MINUTE\*

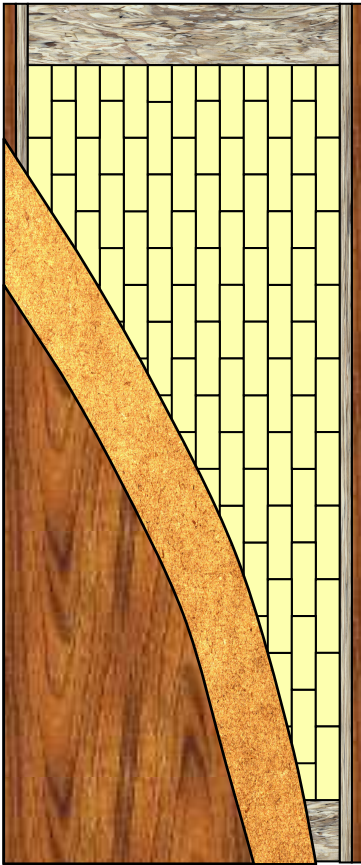

## THICKNESS

Non-rated 1 3/4" , 1 3/8" , 2" , 2 1/4"  
20 Minute\* 1 3/4"

## MAXIMUM SIZE

Single (No Label) 4/0 x 10/0  
Pairs (No Label) 8/0 x 10/0  
Single (20 Minute\*) 3/0 x 9/0 or 4/0 x 8/0  
Pair (20 Minute\*) 8/0 x 8/0 (4/0 each leaf)  
Double Egress Pair (20 Minute\*) 8/0 x 8/0 (4/0 each leaf)  
Door & Transom (20 Minute\*) 3/0 x 10/0 overall

## METHOD OF CONSTRUCTION

5 Ply, Hot Pressed, Bonded Core, Calibrated Thickness.

## CORE

Poplar Staves, Joints Staggered, Bonded Core.

## CROSSBANDS

1/16" or 1/11" Engineered Fiber

## FACE

Wood Veneers, Medium Density Overlays (MDO),  
Decorative High Pressure Laminate.

## STILES

1 5/8" two ply – Outer 1/2" matches face veneer – Inner ply is  
Poplar Lumber or mill option. Bonded to core.

## TOP & BOTTOM RAILS

3 1/2" , mill option. Bonded to Core.

## FACE ASSEMBLY ADHESIVE

Type 1, Waterproof glue

## MAX. LITE OPENINGS

**Non-rated** – Total area of openings not to exceed 1296 sq.  
in. of visible glass or one continuous dimension of 54" in  
height or one continuous dimension of 38" in width  
**20 Minute\*** - Total area of openings not to exceed 1296 sq.  
in. of visible glass or one continuous dimension of 54" in  
height or one continuous dimension of 30" in width

## FINISH

Clear, Custom Stain, Prime, Seal or opaque.

## DETAIL

Factory fitting and complete factory machining including  
lights, louvers and applied moldings

## WARRANTY

Full; Life of original installation  
**Exterior door applications is not recommended or  
warranted**

\* Neutral pressure tested

